



GEOPHYSICAL EXPLORATION SUNDAY NOTICE - FORM GE 4
 INDUSTRIAL COMMISSION OF NORTH DAKOTA
 OIL AND GAS DIVISION
 600 EAST BOULEVARD DEPT 405
 BISMARCK, ND 58505-0840
 SFN 51458 (03-2011)



PERMIT # 970225

Project Name Como Lake 2 D
County Bottineau
Supplemental Information Cancel

Company Bird Seismic Services		Telephone Number (928) 719-1848	
Address Box 1062			
City Globe	State AZ	Zip Code 85502	
Signature 	Printed Name Kenneth Bernstein		
Title President	Date March 29, 2012		
Email Address ken@birdseismic.com			

FOR STATE USE ONLY	
<input type="checkbox"/> Received	<input checked="" type="checkbox"/> Approved
Date 4/24/12	
By 	
Title Mineral Resources Permit Manager	

BIRD SEISMIC SERVICES

COMOLAKE 2D SEISMIC

T164N-R83W

T164N-R82W

T163N-R83W

T163N-R82W

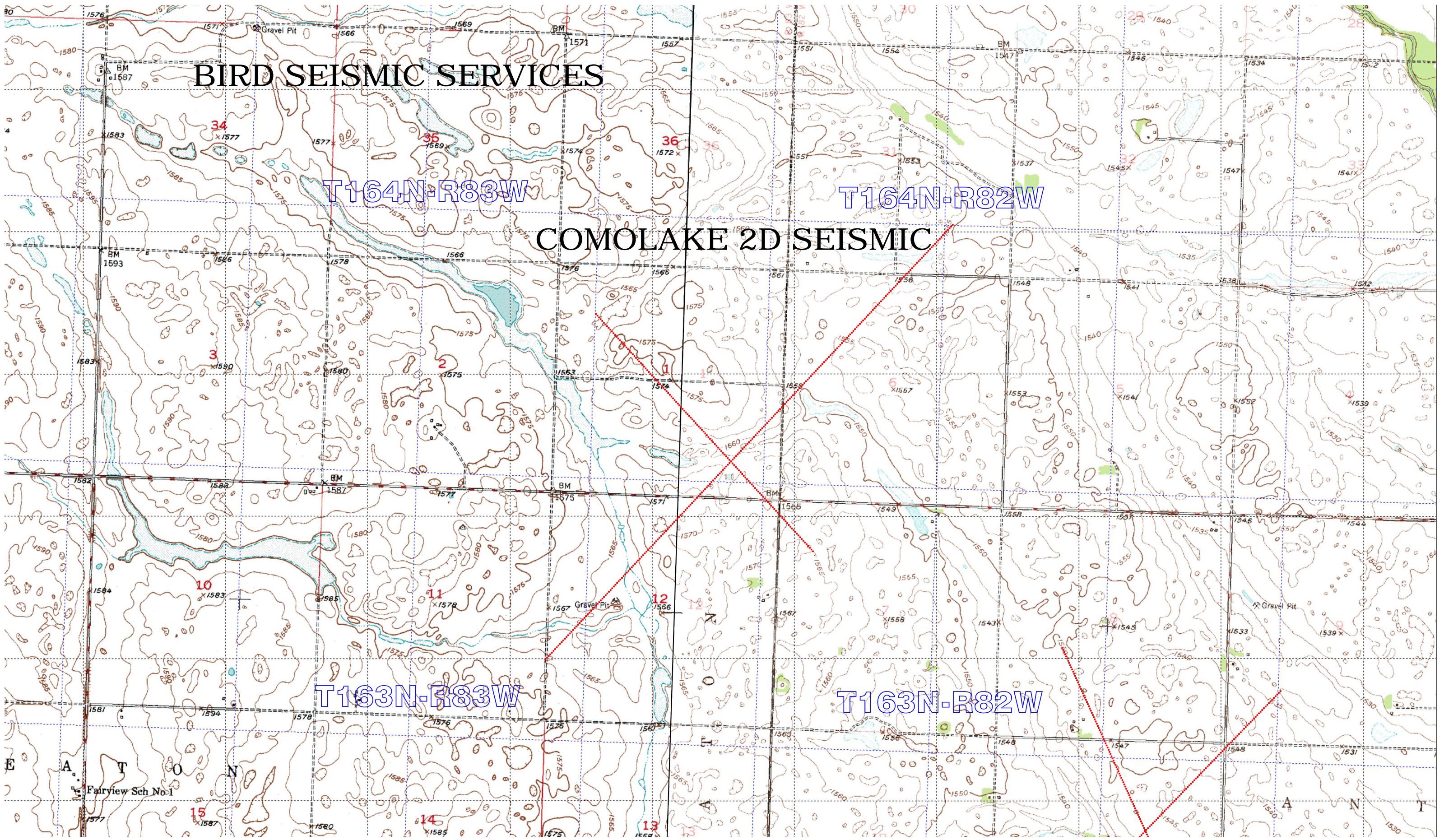

E A T O N
Fairview Sch No 1

A N T

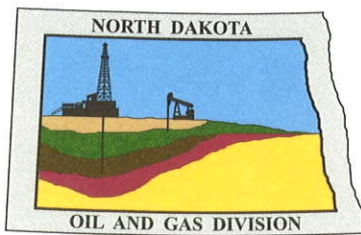

Oil and Gas Division

Lynn D. Helms - Director Bruce E. Hicks - Assistant Director

Department of Mineral Resources

Lynn D. Helms - Director

North Dakota Industrial Commission

www.oilgas.nd.gov

MARCH 6, 2012

MR. KENNETH BERNSTEIN
BIRD SEISMIC SERVICES
P.O. BOX 1062
GLOBE AZ, 85502

RE: COMO LAKE 2-D
 GEOPHYSICAL EXPLORATION PERMIT # 97-0225
 BOTTINEAU COUNTY
 NON EXPLOSIVE METHOD

Dear Mr. Bernstein:

Please be advised that we are in receipt of your Geophysical Exploration permit application and it is conditionally approved; effective for one year from MARCH 6, 2012. **PURSUANT TO NDAC 43-02-12-05 (DISTANCE RESTRICTION) non-explosive exploration method may not be conducted not less than 300 feet from a water well, building, underground cistern, pipelines, and flowing spring.** Review the following conditions for your permit:

1. A pre-program meeting with state seismic inspector Tom Torstenson is required. You must contact him at 701-290-1546 (cell) or 701-227-7436 at least 24 hours prior to any exploration operations. Also, a copy of the entire permit is required for all contractors at the pre-program meeting.
2. All variances for distance restrictions are to be furnished, and a pre-plot map displaying any source points that do not comply with the distance restriction rule must be supplied to the inspector.
3. The following information must be submitted within 30 days of the completion of the project by the Geophysical Company:
 - a. Completion Report,
 - b. Completion Affidavit,
 - c. Post Plot Map. It must show all water wells, buildings, underground cisterns, pipelines, and flowing springs that fall within the program area and within one half mile of the perimeter of the program.
 - d. SD card or email: torstenson@nd.gov with all source and receiver points,
 - e. Letter stating that the Geophysical Company has given all surface owner's a copy of the Section and Chapter of the NDCC as stated in paragraph 5.

4. The following information must be submitted within 30 days of the completion of the project by the SUBCONTRACTOR(s) (when applicable):
 - a. Plugging Report
 - b. Plugging Affidavit
5. It is required that within seven days of initial contact between the permitting agent and the operator of the land, the permitting agent shall provide the operator of the land and each landowner owning land within one-half mile of the land on which geophysical exploration activities are to be conducted a written copy of NDCC Section 38-08.1-04.1 (Exploration Permit) and NDCC Chapter 38-11.1 (Oil and Gas Production Damage Compensation). The permitting agent shall file an affidavit with this office confirming compliance with such notification. For your convenience, a copy of both Sections are enclosed.
6. The permit agent shall notify the operator of the land at least seven days before commencement of any geophysical exploration activity, unless waived by mutual agreement of both parties. The notice must include the approximate time schedule and the location of the planned activity.
7. Information regarding the location of water wells, springs, etc.; refer to the following ND State Water Commission Mapservice website, at: <http://mapservice.swc.state.nd.us/>
8. The entire permit can be viewed, as well as the status of various seismic projects in the state, at: <https://www.dmr.nd.gov/oilgas/seismic/seismicstats.asp>

Should you have any questions regarding this matter, feel free to contact me at 701-328-8020, or Tom Torstenson at the number listed in paragraph 1.

Sincerely,

A handwritten signature in black ink, appearing to read "TODD L. HOLWEGER", followed by a long horizontal line extending to the right.

Todd L. Holweger
DMR Permit Manager



GEOPHYSICAL EXPLORATION PERMIT - FORM GE 1

INDUSTRIAL COMMISSION OF NORTH DAKOTA
 OIL AND GAS DIVISION
 600 EAST BOULEVARD DEPT 405
 BISMARCK, ND 58505-0840
 SFN 51459 (03-2011)



1) a. Company Bird seismic Services, Inc.		Address 10165 S. Ice House Canyon Rd PO Box 1062 Globe AZ 85506			
Contact Kenneth Bernstein		Telephone (928) 719-1848		Fax (928) 425-3342	
Surety Company Cash - Bank of ND		Bond Amount \$25,000.00		Bond Number GEO 303	
2) a. Subcontractor(s) Matrix Surveys		Address 191 University Dr #327 Denver Co.		Telephone (720) 480-8559	
b. Subcontractor(s)		Address		Telephone	
3) Party Manager Kenneth Bernstein		Address (local) C/O Westhope Inn Westhope ND		Telephone (local) (928) 719-1848	
4) Project Name or Line Numbers Como Lake 2D					
5) Exploration Method (Shot Hole, Non-Explosive, 2D, 3D, Other) Weight Drop 2D					
6) Distance Restrictions (Must check all that apply)					
<input checked="" type="checkbox"/> 300 feet - NonExplosive - Distance setbacks apply to water wells, buildings, underground cisterns, pipelines, and flowing springs.					
<input type="checkbox"/> 660 feet - Shot Hole - Distance setbacks apply to water wells, buildings, underground cisterns, pipelines, and flowing springs.					
7) Size of Hole 3-D	Amt of Charge	Depth	Source points per sq. mi.	No. of sq. mi.	
Size of Hole 2-D	Amt of Charge	Depth	Source points per in. mi. 96	No. of in. mi. 4	
8) Approximate Start Date March 7, 2012			Approximate Completion Date April 15, 2012		

THE COMMISSION MUST BE NOTIFIED AT LEAST 24 HOURS IN ADVANCE OF COMMENCEMENT OF GEOPHYSICAL OPERATIONS

9) Location of Proposed Project - County Bottineau						
Section(s), Township(s) & Range(s)	Section	6,7	T.	163 N	R.	82 W
	Section	31	T.	164 N	R.	82 W
	Section	12,1	T.	163 N	R.	83 W
	Section		T.		R.	
	Section		T.		R.	
	Section		T.		R.	

I hereby swear or affirm that the information provided is true, complete and correct as determined from all available records.			Date March 3, 2012
Signature 	Printed Name Kenneth Bernstein	Title President	
Email Address(es) ken@birdseismic.com			

(This space for State office use)		<p align="center">Permit Conditions</p> <p>* Permit in hand required at pre-program meeting with field inspector and be aware of all NDIC Rules and Regulations (i.e. distance restrictions).</p> <p>* See attached letter.</p>
Permit No. 970225	Approval Date 3/6/12	
Approved by 	Title Mineral Resources Permit Manager	

*See Instructions On Reverse Side

Oil and Gas Division

Lynn D. Helms - Director Bruce E. Hicks - Assistant Director

Department of Mineral Resources

Lynn D. Helms - Director

North Dakota Industrial Commission

www.oilgas.nd.gov

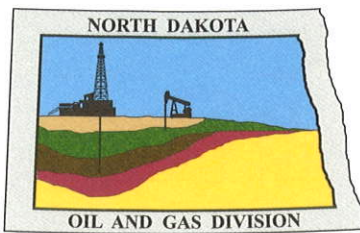

MARCH 6, 2012

The Honorable Lisa Herbel
Bottineau County Auditor
314 West 5th
Bottineau, ND 58318-1204

RE: Geophysical Exploration
Permit # 97-0225

Dear Ms. Steich:

Pursuant to Section 38-08.1-04.2 of the North Dakota Century Code, please be advised that BIRD SEISMIC SERVICE, INC. was issued the above captioned permit on MARCH 6, 2012 and will remain in effect for a period of one year. The entire permit can be viewed on our website at: <https://www.dmr.nd.gov/oilgas/seismic/seismicstats.asp>

Should you have any questions, please contact our office.

Sincerely,



Todd L. Holweger
Mineral Resources Permit Manager